

SECTION B-B

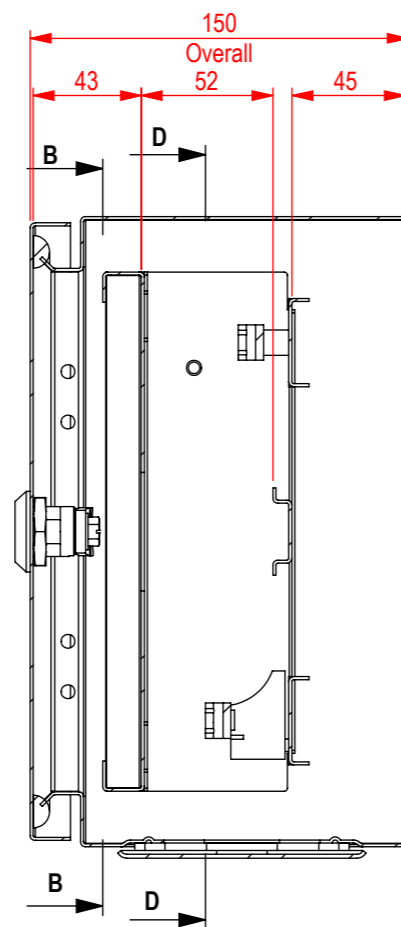

SECTION A-A

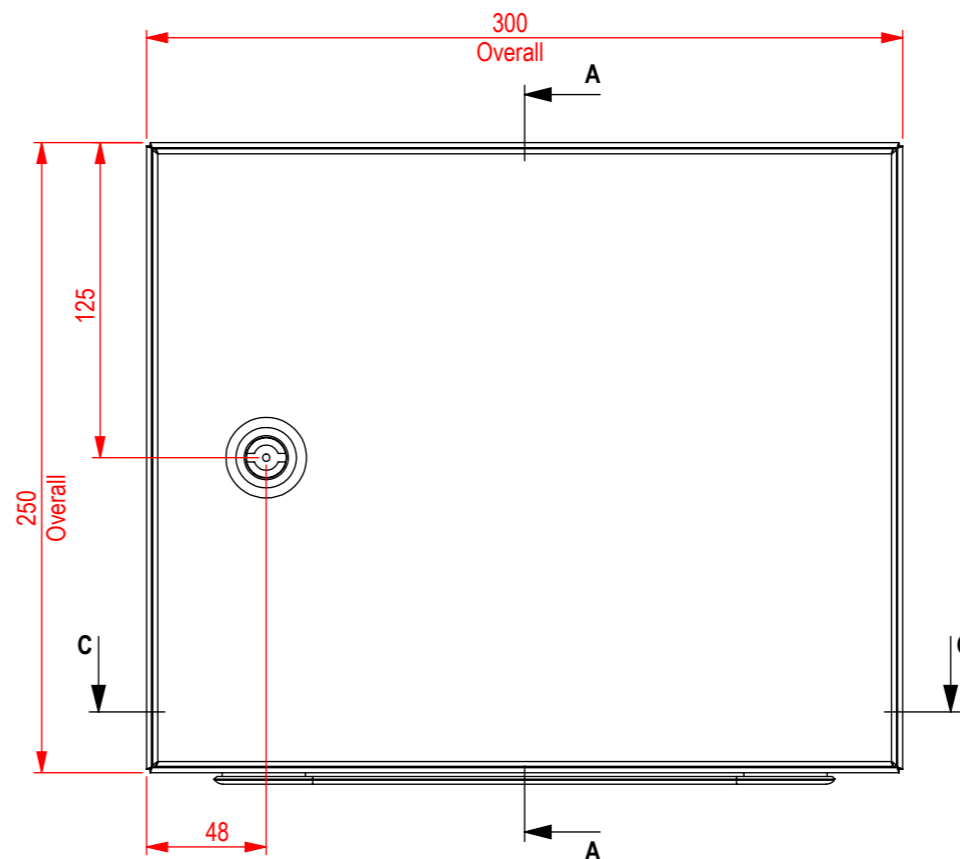

**Specification:**

**Din Rail Enclosure:** 1 x 12 Poles (12 Modules)  
 (Includes Din Rail Insert and Escutcheon Front Plate)  
**Dimension:** 250H x 300W x 150D - Single Door (1 Lock)  
**Degree of Protection:** IP66  
**No. of Hinges:** 2 (Reversible Hinged Door - 120 Degree Opening)  
**Door Seal:** Polyurethane sealing  
**Terminal Bar:** 100Amp Earth and Neutral Brass bar - 2 Screws, 5mm Tunnel, M8 Screw for main cabling  
**No. of Terminal Bar:** 1 x 12-way Earth and 1 x 12-way Neutral Bar  
**Mounting Holes:** 4x Ø8.5mm Rear mounting holes  
**Mounting Bracket:** 4x Stainless steel wall mounting brackets with sealing gasket  
**Gland:** Gland plate with sealing gasket  
**Earth studs:** On door and body  
**Triangle Lock:** Stainless Steel  
**Standard:** Complies with IEC/EN 62208

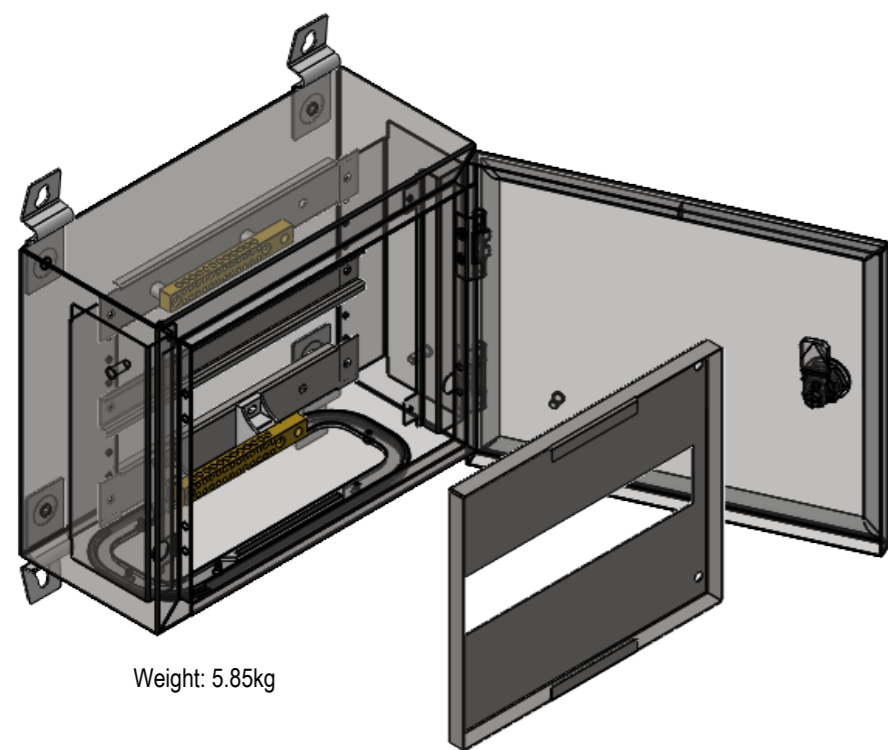

Weight: 5.85kg

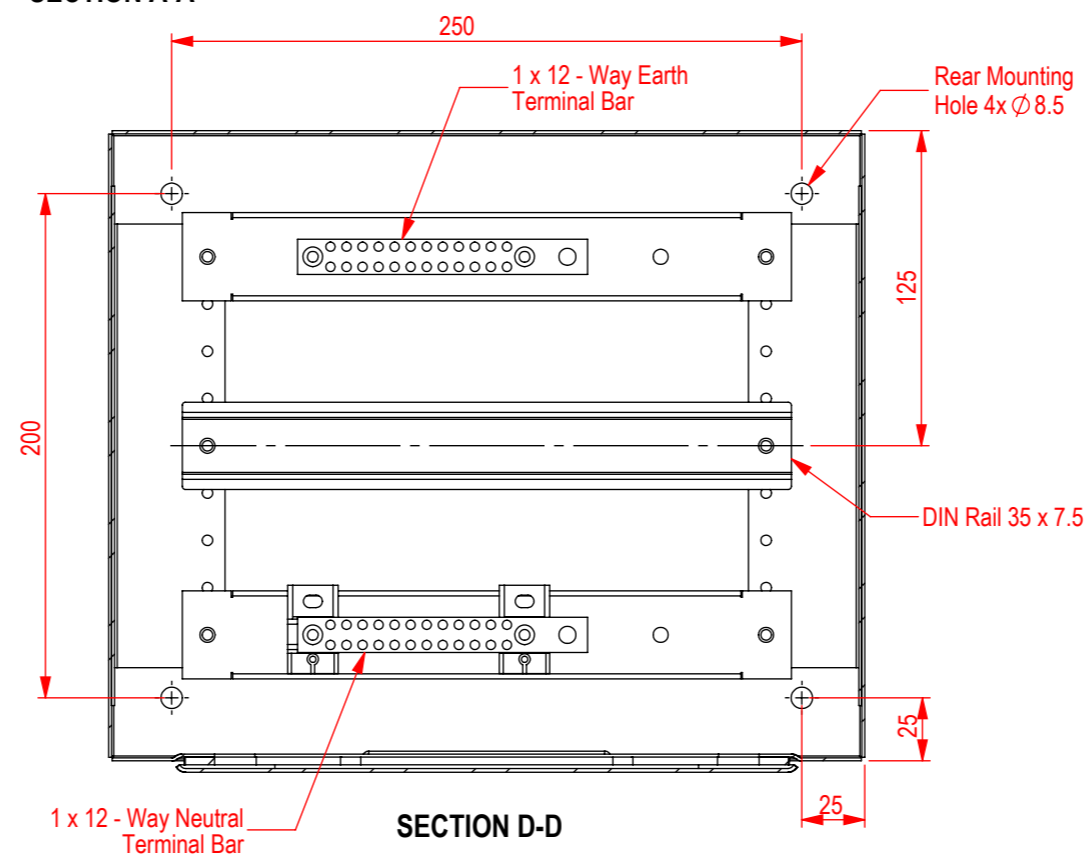

SECTION D-D

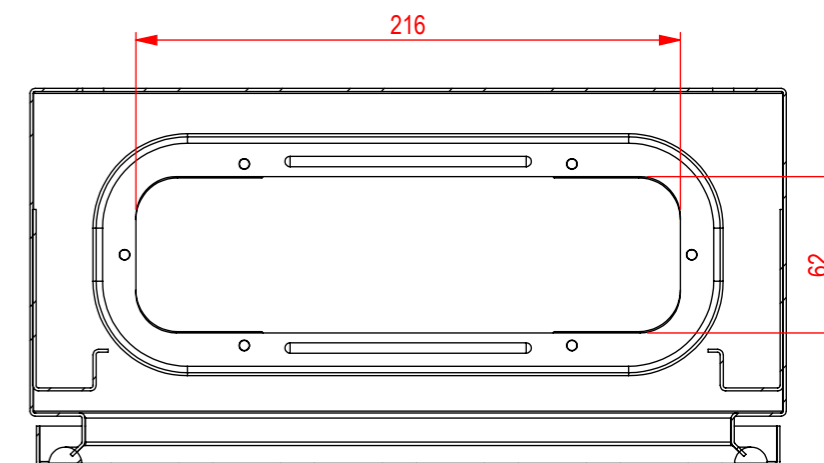

SECTION C-C

**Material:**

Body & Door - 1.2mm Thick 316 Stainless Steel  
 Gland Plate - 1.2mm Thick 316 Stainless Steel  
 Escutcheon Front Plate - 1.2mm Thick Grey Powder Coated Galvanized steel

**Company Confidential**

This drawing and any information or descriptive material set out on it are the confidential and copyright property of Elecron Baal© and MUST NOT BE DISCLOSED, COPIED, LOANED in whole or part or used for any purpose without the written permission of *Elecron Baal*.



2 / 6 Cary Grove Minto NSW 2566, Australia  
 Tel. No: +61 2 72301357  
 email: [info@elecronbaal.com.au](mailto:info@elecronbaal.com.au)  
 Website : <https://elecronbaal.com.au>

Projection: Third Angle

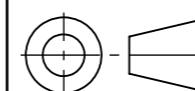

All Dimensions are in mm

Drawn: KS	Description: <b>250 x 300 x 150 SSIPDR Enclosure</b>			
Date: 26/04/2025	Dwg No: <b>SSIPDR112</b>			
Checked: BA	Material: 316 Stainless Steel (SS)	Weight: 5.85kg		
Issued on: 28/04/2025	Revision: A	Scale: NTS	A3	Sheet: 1 / 1