

SECTION A-A

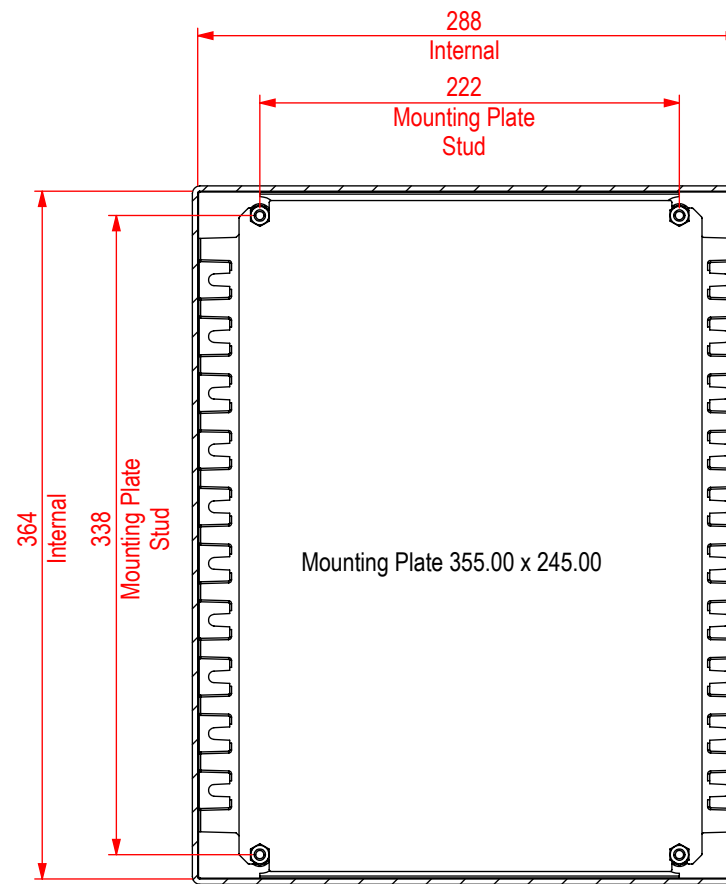

SECTION B-B

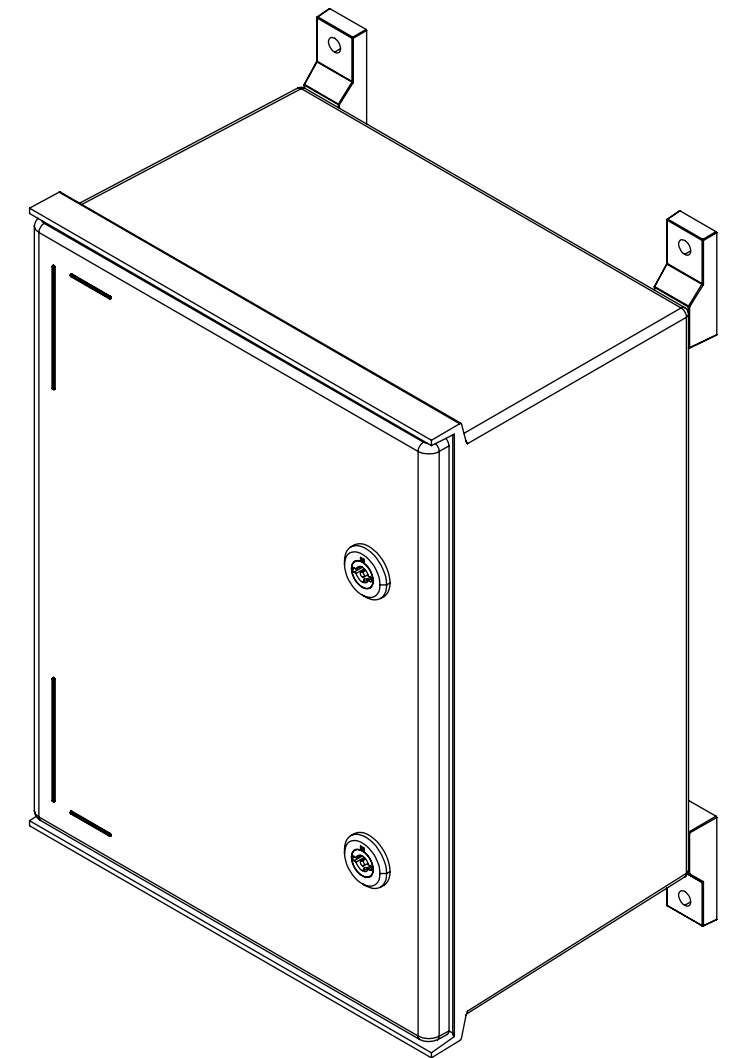

Specification:

- SMC Fiberglass reinforced Polyester provide strength and durability.
- IP 65 Protection.
- Excellent corrosive resistance.
- UV stabilised.
- Non-conductive material ensure electrical safety.
- Light Weight: High strength to weight ratio.
- 1.5mm Galvanised Mounting Plate.
- Continuous Door seal.
- Grey RAL 7035 colour.
- 180 degree door opening.
- Easy to machine.
- Working temperature -40 to +120 °C

Material:

- SMC Fiberglass reinforced Polyester
- Finish: RAL 7035 Grey Colour

Company Confidential

This drawing and any information or descriptive material set out on it are the confidential and copyright property of Elecron Baal. © and MUST NOT BE DISCLOSED, COPIED, LOANED in whole or part or used for any purpose without the written permission of *Elecron Baal*.



2 / 6 Cary Grove Minto NSW 2566, Australia
Tel. No: +61 2 72301357
email: info@elecronbaal.com.au
Website : <https://elecronbaal.com.au>

Projection: Third Angle

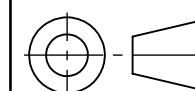

All Dimensions
are in **mm**

Drawn: SS	Description: 400 x 300 x 200 GRP Enclosure			
Date: 8/06/2025	Dwg No: FB403020			
Checked: BA	Material:		Weight:	
Issued on: 09/06/2025	Revision: A	Scale: NTS	A3	Sheet: 1 / 1