

#### Specification:

- SMC Fiberglass reinforced Polyester provide strength and durability.
- IP 65 Protection.
- Excellent corrosive resistance.
- UV stabilised.
- Non-conductive material ensure electrical safety.
- Light Weight: High strength to weight ratio.
- 1.5mm Galvanised Mounting Plate.
- Continuous Door seal.
- Grey RAL 7035 colour.
- 180 degree door opening.
- Easy to machine.
- Working temperature -40 to +120 °C

#### Material:

- SMC Fiberglass reinforced Polyester
- Finish: RAL 7035 Grey Colour

#### Company Confidential

This drawing and any information or descriptive material set out on it are the confidential and copyright property of Elecron Baal.© and MUST NOT BE DISCLOSED, COPIED, LOANED in whole or part or used for any purpose without the written permission of *Elecron Baal*.



2 / 6 Cary Grove Minto NSW 2566, Australia  
Tel. No: +61 2 72301357  
email: [info@elecronbaal.com.au](mailto:info@elecronbaal.com.au)  
Website : <https://elecronbaal.com.au>

Projection: Third Angle

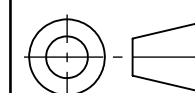

All Dimensions  
are in **mm**

Drawn: SS	Description: <b>300 x 250 x140 GRP Enslosure</b>			
Date: 8/06/2025	Dwg No: <b>FB302514</b>			
Checked: BA	Material:	Weight:		
Issued on: 09/06/2025	Revision: A	Scale: NTS	A3	Sheet: 1 / 1