

SECTION A-A

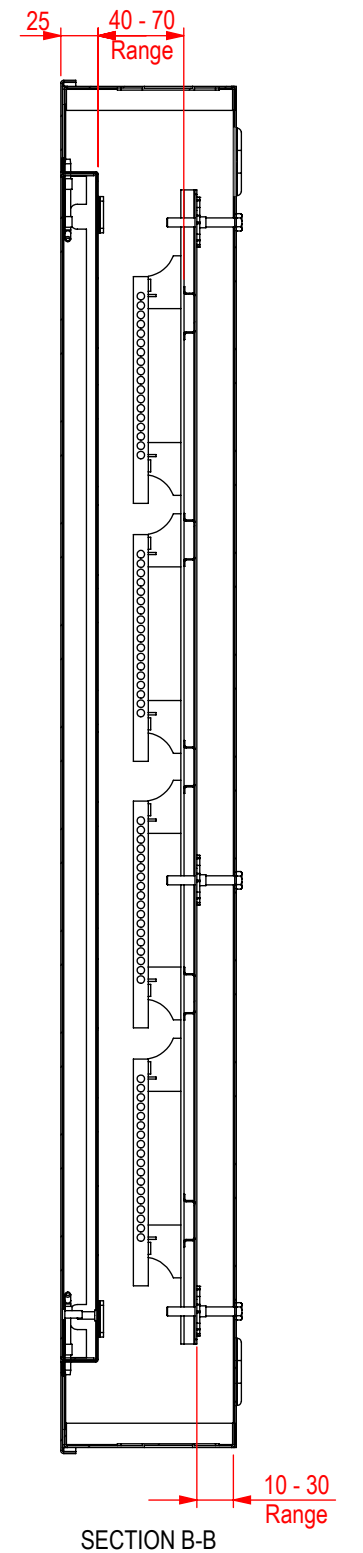
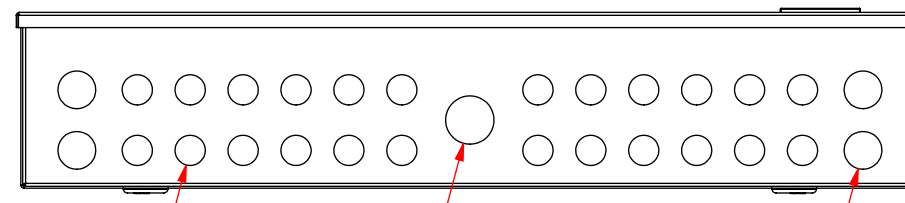
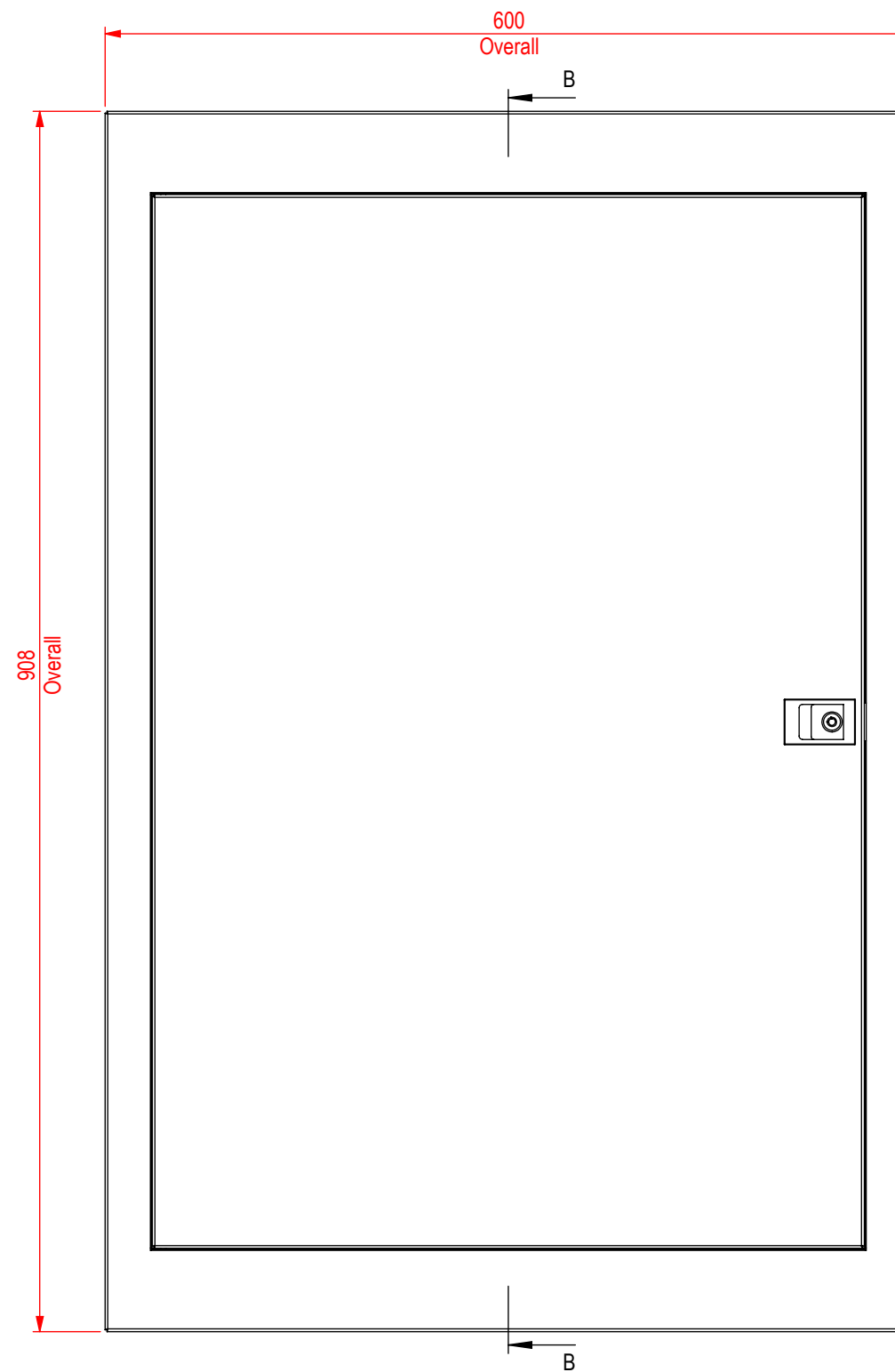

Material:

- Galvanised Sheet 1.2mm Thick
- Finish: RAL 7035 Grey Colour Powder Coated

Company Confidential

This drawing and any information or descriptive material set out on it are the confidential and copyright property of Elecron Baal.® and MUST NOT BE DISCLOSED, COPIED, LOANED in whole or part or used for any purpose without the written permission of *Elecron Baal*.



2 / 6 Cary Grove Minto NSW 2566, Australia
Tel. No: +61 2 72301357
email: info@elecronbaal.com.au
Website : <https://elecronbaal.com.au>

Projection: Third Angle

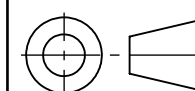

All Dimensions are in mm

Drawn: SS	Description: 908 x 600 x 115 Enclosure DR Series			
Date: 23/05/2025	Dwg No: DR524			
Checked: BA	Material:		Weight: 19.8 Kg	
Issued on: 23/05/2025	Revision: A	Scale: NTS	A3	Sheet: 1 / 2

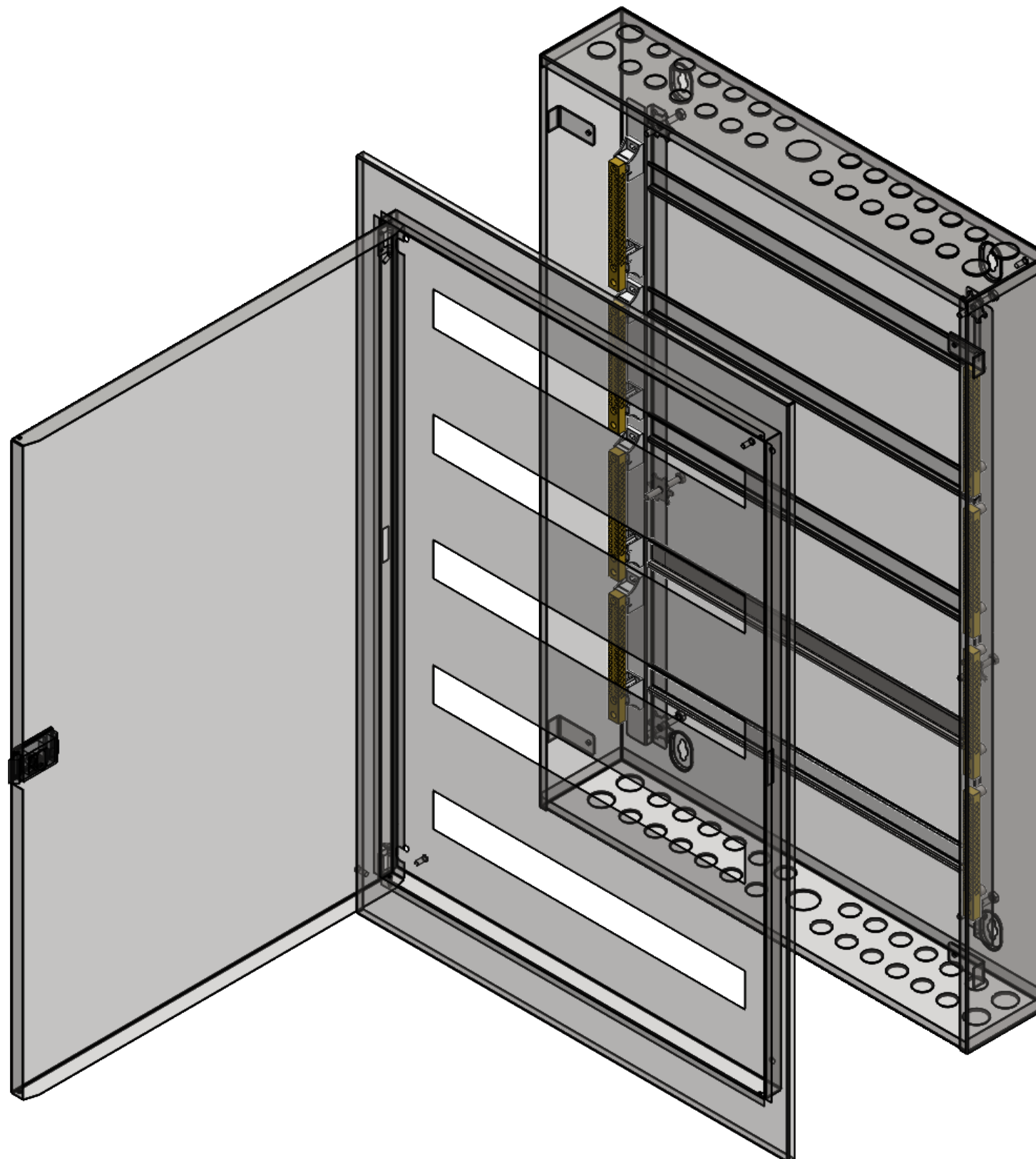

Specification:

- **Din Rail Enclosure DR Series:** 5 x 24 Poles (120 Modules)
- **Rated :** 100 Amp
- **Dimension:** 908 x 600 x 115 Enclosure DR Series
- **Degree of Protection:** IP20 for indoor Installation
- **Hinges:** Spring loaded Pin- Removable / Reversible Hinged Door
- **Door :** Lockable Door
- **Terminal Bar:** 100Amp Earth and Neutral Brass bar - 2 Screws, 5mm Tunnel, M8 Screw for main cabling
- **No. of Terminal Bar:** 4 x 18-way Earth and 4 x 18-way Neutral Bar
- **Earth studs:** On door and body
- Knock Outs Top and Bottom
- Include Din rail and Front Plate
- **Standard:** Complies with AS/NZS 60670.1

Material:

- Galvanised Sheet 1.2mm Thick
- Finish: RAL 7035 Grey Colour Powder Coated

Company Confidential

This drawing and any information or descriptive material set out on it are the confidential and copyright property of Elecron Baal. © and MUST NOT BE DISCLOSED, COPIED, LOANED in whole or part or used for any purpose without the written permission of **Elecron Baal**.



2 / 6 Cary Grove Minto NSW 2566, Australia
Tel. No: +61 2 72301357
email: info@elecronbaal.com.au
Website : <https://elecronbaal.com.au>

Projection: Third Angle

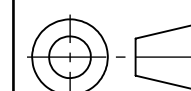

All Dimensions
are in **mm**

Drawn: SS	Description: 908 x 600 x 115 Enclosure DR Series			
Date: 26/05/2025	Dwg No: DR524			
Checked: BA	Material:	Weight: 19.8 Kg		
Issued on: 26/05/2025	Revision: A	Scale: NTS	A3	Sheet: 2 / 2